

Biobore Tees

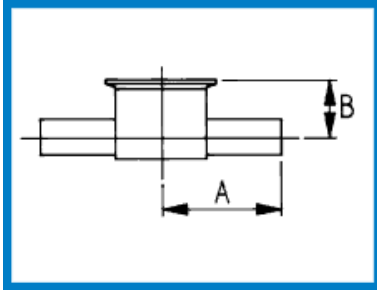

a  company



DT28 - Instrument Tee W/W/C (DT-4.1.2-10) ✓ ASME BPE

Size (ins)	Part Code	A (mm)	B (mm)
1.0 x 0.5 **	IT1005WWCSTDT28 **	63.5	22.2
1.0 x 0.75 **	IT1007WWCSTDT28 **	63.5	25.4
1.5 x 0.5	IT1505WWCSTDT28	63.5	22.2
1.5 x 0.75	IT1507WWCSTDT28	63.5	25.4
1.5 x 1.0	IT1510WWCSTDT28	63.5	28.6
2.0 x 0.5	IT2005WWCSTDT28	69.8	25.4
2.0 x 0.75	IT2007WWCSTDT28	69.8	28.6
2.0 x 1.0	IT2010WWCSTDT28	69.8	31.8
2.0 x 1.5	IT2015WWCSTDT28	69.8	38.1
2.5 x 0.5 **	IT2505WWCSTDT28 **	85.0	35.0
2.5 x 0.75 **	IT2507WWCSTDT28 **	85.0	38.1
2.5 x 1.0 **	IT2510WWCSTDT28 **	85.0	41.3
2.5 x 1.5 **	IT2515WWCSTDT28 **	85.0	44.5
2.5 x 2.0 **	IT2520WWCSTDT28 **	85.0	48.0
3.0 x 0.5 **	IT3005WWCSTDT28 **	90.0	38.1
3.0 x 0.75 **	IT3007WWCSTDT28 **	90.0	41.3
3.0 x 1.0 **	IT3010WWCSTDT28 **	90.0	44.5
3.0 x 1.5 **	IT3015WWCSTDT28 **	90.0	48.0
3.0 x 2.0 **	IT3020WWCSTDT28 **	90.0	50.8
3.0 x 2.5 **	IT3025WWCSTDT28 **	90.0	54.0
4.0 x 0.5 **	IT4005WWCSTDT28 **	110.0	79.4
4.0 x 0.75 **	IT4007WWCSTDT28 **	110.0	82.6
4.0 x 1.0 **	IT4010WWCSTDT28 **	110.0	85.7
4.0 x 1.5 **	IT4015WWCSTDT28 **	110.0	88.9
4.0 x 2.0 **	IT4020WWCSTDT28 **	110.0	95.2
4.0 x 2.5 **	IT4025WWCSTDT28 **	110.0	98.4
4.0 x 3.0 **	IT4030WWCSTDT28 **	110.0	101.6

** Size not covered under ASME BPE

Stainless Fittings. Tipton Road, Dudley, West Midlands DY1 4SQ

Tel: +44 (0)121 557 1188

E-mail: stainlessfittings@sfluk.co.uk **www.sfluk.co.uk**

